

DATA CONTAINED IN THIS DOCUMENT IS PROPRIETARY TO TROMPETER ELECTRONICS INC. AND SHALL NOT BE DISCLOSED, COPIED OR USED FOR PROCUREMENT OR MANUFACTURE WITHOUT EXPRESS WRITTEN PERMISSION OF TROMPETER ELECTRONICS INC.

**REVISIONS**

010-0203 SH 1

REV	DESCRIPTION	DATE	APPROVED
A	PRODUCTION RELEASE		<i>WJ</i>

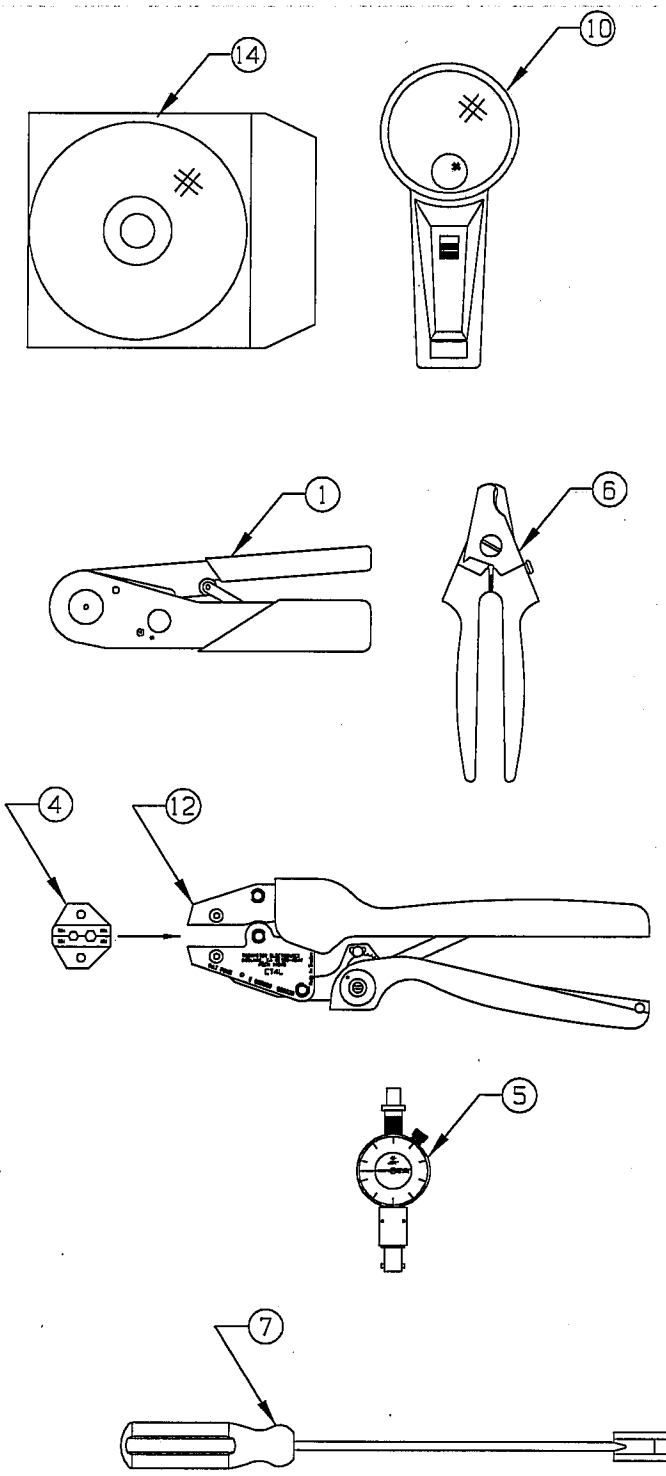
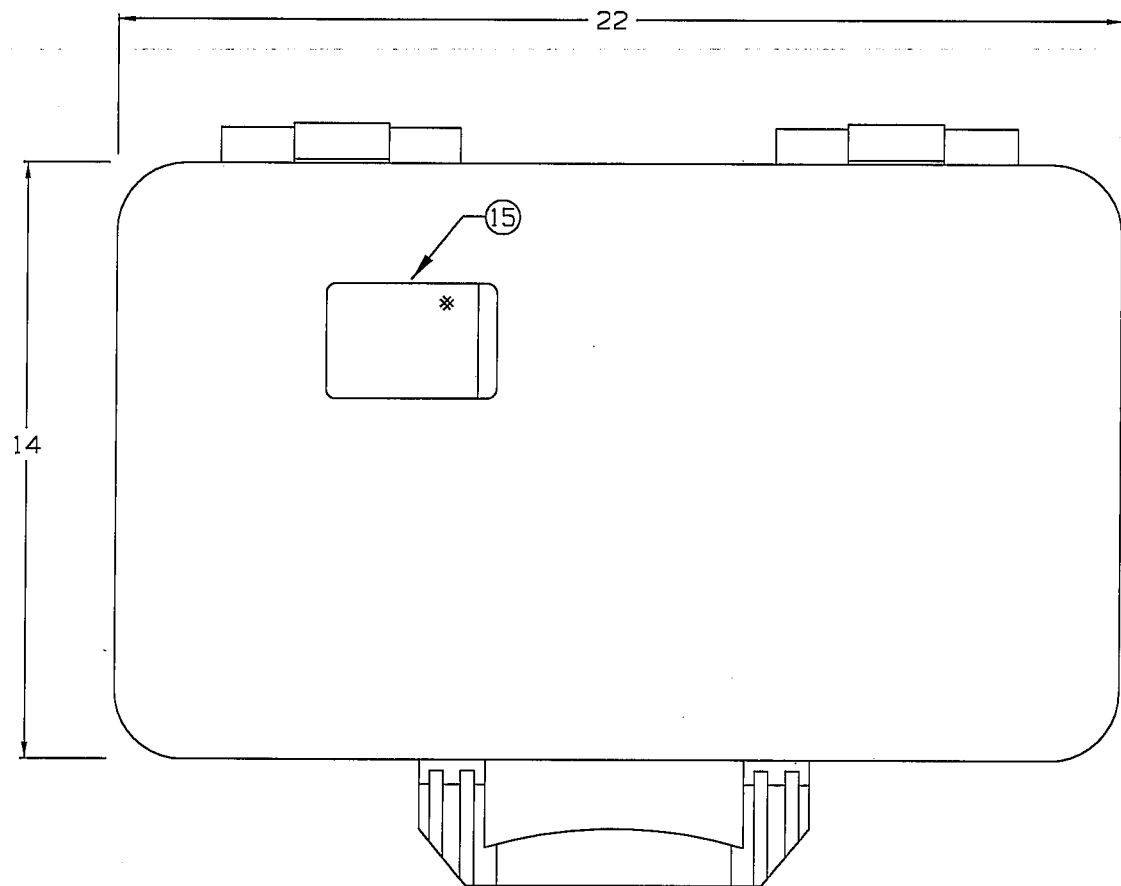

**RED INDICATES ORIGINAL**

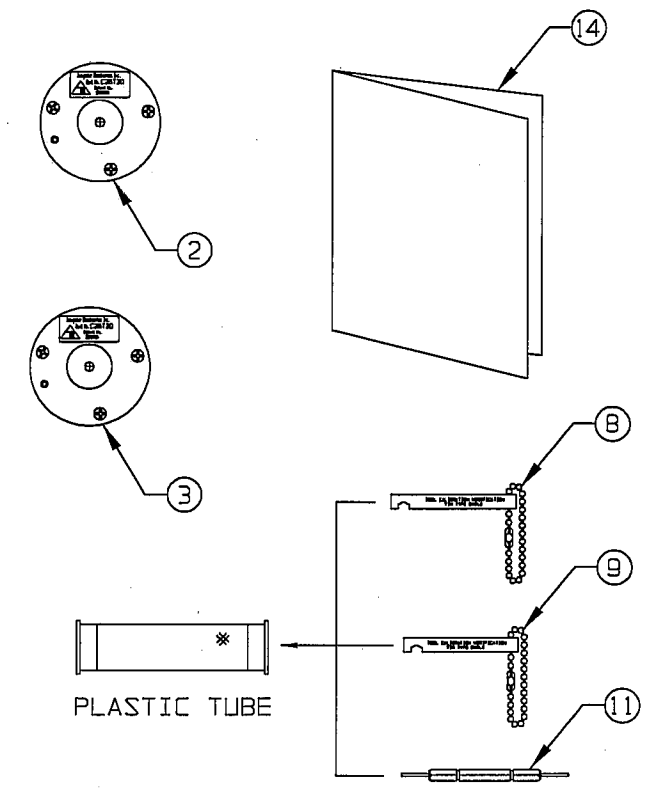

3. SBC PID# 301140059

2. CASE CONTENT:

1. MULTIPPOINT INDENTER CENTER CONTACT CRIMPER
2. CUTTER HEAD FOR 735 (INSTALLED IN ITEM 2)
3. CUTTER HEAD FOR 734
4. FLIP FLOP DIE SET (INSTALLED IN ITEM 13)
5. MITUTOYO PIN HEIGHT GAUGE
6. CABLE CUTTER
7. BNC STRAIGHT & RIGHT ANGLE REMOVAL TOOL
8. GAUGE FOR 735 CRIMP AREA
9. GAUGE FOR 734 CRIMP AREA
10. MAGNIFYING GLASS WITH BUILT-IN LIGHT
11. CONTACT CRIMPER PIN GAUGE
12. CRIMPER FOR CRIMP SLEEVE
13. ASSEMBLY INSTRUCTION FOR TEI'S BNC
14. CATALOG ON A CD
15. BUSINESS CARD HOLDER

1. CASE INCLUDES WHEELS AND EXTENDABLE HANDLE FOR EASY TRANSPORTATION. MADE OF HIGH IMPACT BLACK GLASS-FILLED NYLON. WATER RESISTANT. MEETS AIRLINE REQUIRMENTS FOR CARRY ON LUGGAGE. AREA TO ADD 2 PADLOCKS FOR EXTRA SECURITY. TEMP RATED -10° F (-23° C) TO +210° F (+99° C)

INTERPRET DRAWING PER MIL-STD-100 DIMENSIONS ARE IN INCHES AND INCLUDE FINISH THICKNESS UNLESS OTHERWISE SPECIFIED		TOL: UNLESS SPECIFIED .XX ± .01 .XXX ± .003 .XXXX ± .0010 ANGLES ± 0° 30'			
DRAWN: AAH CHECKED: <i>JX</i> QUALITY: <i>MS</i> MAN: <i>SK</i> APPROVED: <i>WJ</i>	DATE: 12-1-04 DATE: 12-6-04 DATE: 12/1/04	MATERIAL:	FINISH:		
NEXT ASSY	CAD FILE NO: 010-0203A	DO NOT SCALE DWG	SCALE: 1/4	SIZE: B CAGE CODE: 14949	DRAWING NO.: 010-0203 DATE: 12-7-04 SHEET: 1c